



TRUE NORTH WOOD HEATERS

**TN10 & TN20 FREESTANDING
TN20 INBUILT**



*Made in Canada,
for Canadian Winters*

FREESTANDING

True North wood heaters offer an exceptional cost to performance ratio. Featuring quad burn tubes as part of the combustion system, and fully firebrick lined, the TN10 and TN20 are an effective solution for a price-minded wood heater. Each wood heater is engineered for high efficiency and constructed with 10-gauge steel, a gasketed cast iron door, and a clean glass airwash system. 100% made in Canada with a 5 year warranty.



TN10 FREESTANDING

Heat Output	120–150 m²	
Efficiency	★★★★★	64%
Emissions	★★★★★	1.2 gm/kg
Burn Time	6–8 hours	
Log Size (max)	25–30 cm	
Weight	89 kg	

TN20 FREESTANDING

Heat Output	200–220 m²	
Efficiency	★★★★★	62%
Emissions	★★★★★	1.1 gm/kg
Burn Time	8–12 hours	
Log Size (max)	40–45 cm	
Weight	154 kg	

FEATURES

Reliable catalytic-free technology
Boost air
Heavy plate-steel top
Leg and pedestal model available (TN20 only)

Even heat distribution
Quad burn performance with 4 secondary airtubes
Air wash system for super clean ceramic glass

Inside and outside combustion air capable
Single-Lever Air Control
Cast iron door
Optional fan

INBUILT

Convert an existing fireplace into a source of efficient heat with the TN20 inbuilt wood heater. This powerful firebox will heat small to medium spaces, burn cleanly and will offer years of trouble free warmth. The gasketed cast iron door seals the firebox to avoid unnecessary air loss, while clean air-wash technology ensures a full view of the fire while in use.



TN20 INBUILT

Heat Output	200–220 m²	
Efficiency	★★★★★	67%
Emissions	★★★★★	1.2 gm/kg
Burn Time	8–12 hours	
Log Size (max)	40–45 cm	
Weight	128 kg	



FEATURES

Reliable catalytic-free technology
Even heat distribution
Quad burn performance with
4 secondary airtubes

Air wash system for super clean
ceramic glass
Inside and outside combustion
air capable

Single-Lever Air Control
Cast iron door
Fan standard

TN10 FREESTANDING

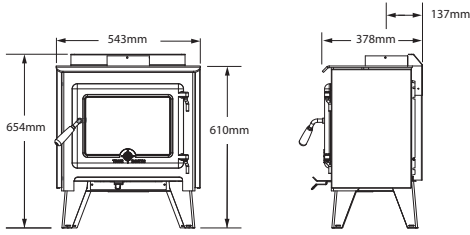

CLEARANCES TO COMBUSTIBLES (MM)

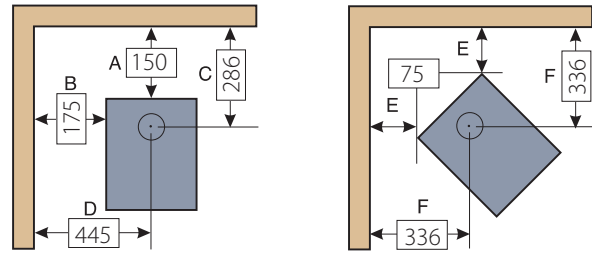

TN20 FREESTANDING

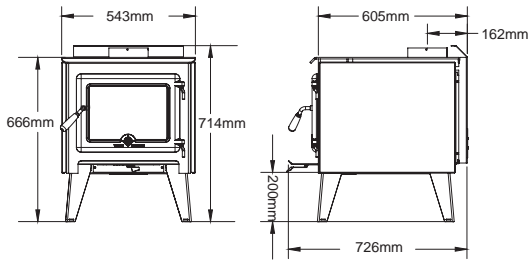

CLEARANCES TO COMBUSTIBLES (MM)

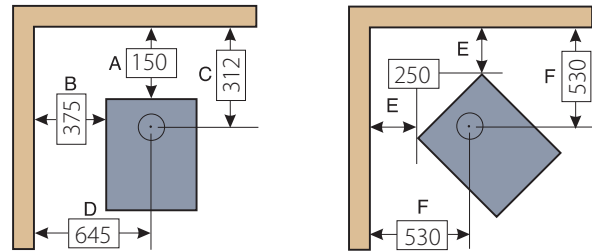

TN20 INBUILT

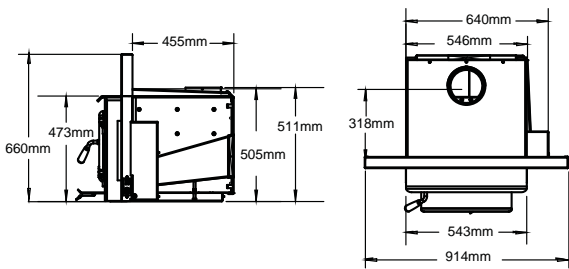

MINIMUM FIREPLACE OPENING (MM)

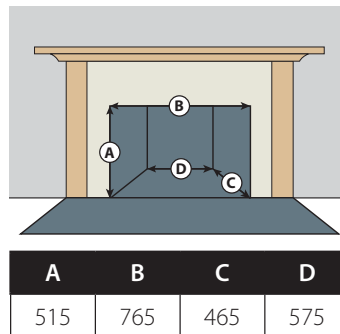

CLEARANCES TO COMBUSTIBLES (MM)

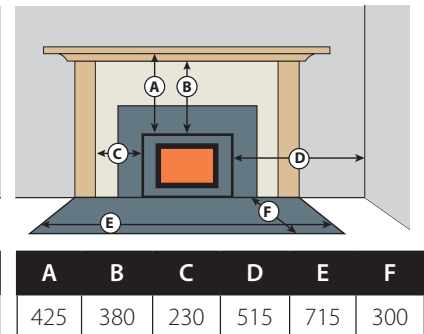

HEARTH REQUIREMENTS (MM)

	Minimum Floor Protector (width x length)	Extending in front of door opening	From side of door opening	Thickness
TN10 FREESTANDING	715 x 640	300	200	9
TN20 FREESTANDING	714 x 1090	300	200	9
TN20 INBUILT (545w x 720d x 110 thick Clay Bricks)	715 x 450	300	200	9

* all products subject to change without warning Due to the limitations of the printing process, it is not possible to replicate colours exactly in a print format. Please check with your local Pacific Energy retailer for colour samples.

Canadian-made Woodstoves and Inbuilts proudly distributed by Pivot Stove & Heating Australia in conjunction with Pacific Energy Fireplace Products

For more information and current product updates, visit pivotstove.com.au

